



INSTRUCTION MANUAL

CONTENTS

- 02 Precautions for safe use
- 04 Terms of Parts
- 06 How to Disassemble : Chamber
- 07 How to Prepare Ingredients / Use by Strainer Types
- 08 How to assemble : For juicing
- 10 How to assemble : For making Ice cream
- 12 How to assemble the chamber set and body
- 13 Cautions during Operation
- 14 How to use : For juicing / Ice cream
- 15 How to use control lever by mode
- 16 How to use control lever by ingredients (Juicing)
- 17 When squeezing screw stops during operation
- 18 Assembling and cleaning for squeezer
- 19 Using the squeezer
- 20 How to Clean / How to Clean : Silicones
- 22 Before Requesting for Repair
- 24 Product Specifications / Warranty

Versapers 5G (For Household Use Only / Warranty Included)

1. Read 'Precautions for safe use' (Page 2) and use the appliance properly.
2. After finish reading the manual, keep it in a convenient location for future reference.
3. Do not use it abroad which has different power supply and voltage.
4. Any quality improvements are subject to change without notice.

02

01 You should read <Precautions for safe use>
02 You should follow <Precautions for safe use>
03 Precautions are classified as follows.



Warning When violating the labeling requirement, it may cause serious injury or death.

Precautions for safe use

DO NOT PLUG IN NOR UNPLUG WITH WET HANDS. It may cause electric shock or injury.

DO NOT USE OTHER THAN 230 V - 240 V AC. It may cause electric shock, fire or abnormal performance. If the voltage is different, it may shorten the life of the motor or cause a failure.

PLUG THE POWER CORD CORRECTLY AND PUSH IT TIGHT IN A WALL SOCKET. It may cause an electric shock or a fire.

IF THE SUPPLY CORD IS DAMAGED, IT MUST BE REPLACED BY THE MANUFACTURER'S ITS SERVICE OR SIMILARLY QUALIFIED PERSONS IN ORDER TO AVOID A HAZARD. If the power cord is damaged, it may cause electric shock or fire.

NEVER ALTER THE APPLIANCE. ALSO, DO NOT DISASSEMBLE NOR REPAIR BY YOURSELF. DO NOT INSERT FINGERS, FOREIGN SUBSTANCES OR OBJECTS SUCH AS PINS INTO GAPS OR HOLES IN THE BASE. It may cause a fire, electric shock or failure. For any technical support, contact the authorized local Customer Care Center.

WHEN THE POWER CORD, WIRE IS BROKEN OR DAMAGED OR THE PLUG-IN PART BECOMES LOOSE, DO NOT OPERATE IT. It may cause electric shock, fire or injury.

DO NOT MOISTEN THE BASE OR SPLASH WATER ON THE BASE. Be careful not to let any liquids or other substances get into the switch on the appliance.

DO NOT OPERATE THE SWITCH WITH WET HANDS. It may cause an electric shock or fire.

FOR SAFETY, MUST DO GROUNDING CONNECTION. ALSO, DO NOT DO GROUNDING ON GAS PIPE, PLASTIC WATER PIPE, TELEPHONE WIRE, ETC. It could cause electric shock, fire, malfunction or explosion. Be sure to use the electrical outlet with ground connection.

NEVER DISASSEMBLE THE CHAMBER SET DURING OPERATION NOR INSERT FINGERS, FOREIGN OBJECTS SUCH AS FORKS, SPOONS, ETC. INTO THE HOPPER CHUTE OR JUICE OUTLET. It may cause injury, accident or failure.

APPLIANCES CAN BE USED BY PERSONS WITH REDUCED PHYSICAL, SENSORY OR MENTAL CAPABILITIES OR LACK OF EXPERIENCE AND KNOWLEDGE IF THEY HAVE BEEN GIVEN SUPERVISION OR INSTRUCTION CONCERNING USE OF THE APPLIANCE IN A SAFE WAY AND IF THEY UNDERSTAND THE HAZARDS INVOLVED. CHILDREN SHALL NOT PLAY WITH THE APPLIANCE. CLEANING AND USER MAINTENANCE SHALL NOT BE MADE BY CHILDREN. THIS APPLIANCE SHALL NOT BE USED BY CHILDREN. KEEP THE APPLIANCE OUT OF REACH OF CHILDREN.

DO NOT OPERATE WITHOUT LOCKING THE HOPPER PROPERLY. It may cause an injury or a failure.

WHEN DETECTING A GAS LEAK, DO NOT INSERT THE POWER CORD INTO ITS SLOT. OPEN THE WINDOW TO VENTILATE FULLY AND IMMEDIATELY. It may cause injury or failure.

03



Warning When violating the labeling requirement, it may cause serious injury or damage to the appliance.

NEVER PUT A FINGER, FORK OR SPOON, ETC. INTO THE JUICE OUTLET. It may cause injury or failure.

IF THE SQUEEZING SCREW ROTATION IS STOPPED FROM NORMAL OPERATION, PRESS [REV] BUTTON AND HOLD FOR 3-5 SECONDS AND THEN AFTER REVERSE OPERATION IS COMPLETELY STOPPED, PRESS [ON] BUTTON AGAIN. If such a stop event continues during the operation, the parts may be damaged and performance may be deteriorated due to overheating in a motor. When the problem continues, immediately stop the appliance and contact the local Customer Care Center.

DURING THE OPERATION, DO NOT ATTEMPT TO MOVE THE BASE, DISASSEMBLE THE CHAMBER SET OR PARTS, AND TRY TO LOCK THEM. It may cause an injury or a failure. Any act of event needed, switch off first and unplug the power cord.

WHEN USING THE APPLIANCE, BE CAREFUL FOR A NECKTIE, LONG NECKLACE, SCARF, ETC. NOT TO BE ENTANGLED INTO THE HOPPER CHUTE. It may cause injury, failure or breakage.

PLACE THE APPLIANCE ON A FLAT AND STABLE SURFACE. It may cause injury or failure.

DO NOT OPERATE THE APPLIANCE FOR MORE THAN 30 MINUTES AT A TIME. It may cause a motor failure due to overheating. Cool it down sufficiently about 5 minutes and operate it again.

WHEN PLACING INGREDIENTS INTO THE HOPPER CHUTE, ONLY USE THE PUSHER PROVIDED. It may cause injury or failure.

DO NOT ALLOW A SEVERE SHOCK TO THE APPLIANCE NOR DROP IT. It may cause electric shock, fire or damage.

IF THE APPLIANCE GIVES OFF AN UNPLEASANT SMELL OR EXCESSIVE HEATING, SMOKE, STOP USING IMMEDIATELY AND CONTACT THE LOCAL CUSTOMER CARE CENTER. When using a new appliance, it gives off a smell and the smell disappears naturally over time.

ALWAYS UNPLUG THE APPLIANCE AFTER USE. ALWAYS DISCONNECT THE APPLIANCE FROM THE SUPPLY IF IT IS LEFT UNATTENDED AND BEFORE ASSEMBLING, DISASSEMBLING OR CLEANING. WHEN UNPLUGGING THE POWER CORD, MAKE SURE TO HOLD THE POWER CORD. Pulling on the wire to unplug may cause electric shock or fire.

DO NOT WASH AT HIGH TEMPERATURES OF 80°C OR HIGHER. DO NOT PUT THE APPLIANCE IN A DISHWASHER, A DRYER OR A MICROWAVE ETC. It may cause a failure or parts deformation.

THE APPLIANCE WEIGHS ABOUT 6.3kg. WHEN MOVING THE APPLIANCE, ENSURE TO MOVE IT HOLDING GRIPS TIGHTLY AT THE BASE BOTTOM WITH BOTH HANDS. If attempting to hold chamber or the edge of the base, the base falls causing an injury or failure.

DO NOT USE HOUSEHOLD PRODUCTS FOR COMMERCIAL PURPOSES. Forcing a large amount of ingredients to be extracted may damage the parts. Please contact the Customer Service Center for information on how to use the product for commercial purposes.

Terms of Parts

01 Hopper

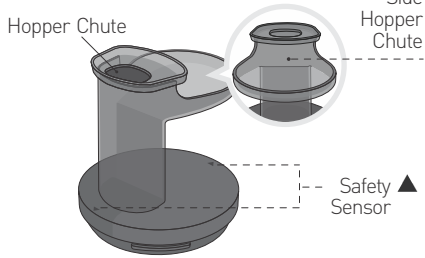

02 Spinning Brush

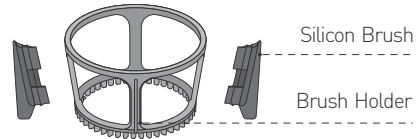

03 Squeezing Screw

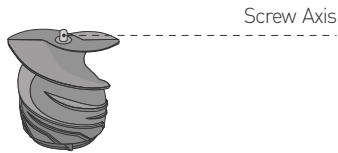

04 Chamber

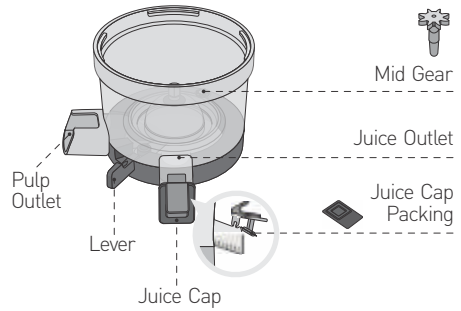

05 Pusher

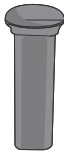

06 Fine Strainer

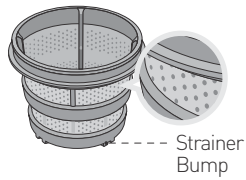

07 Ice cream Strainer

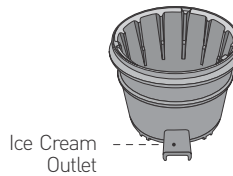

08 Juice Container



09 Pulp Container

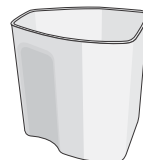

05

Terms of Parts

10 Base

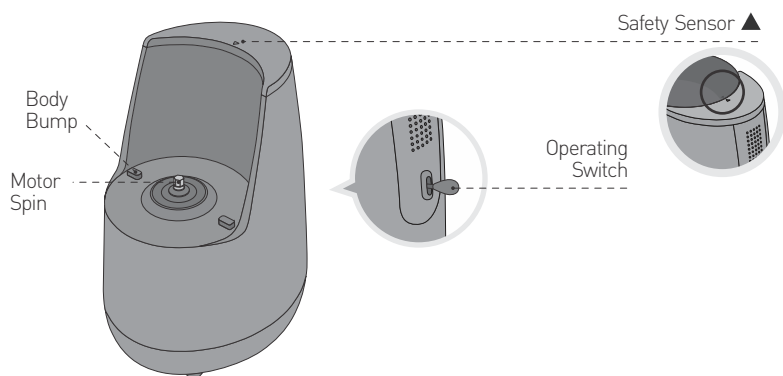

11 Cleaning Brush

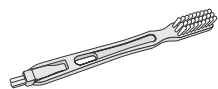

12 Squeezer Set

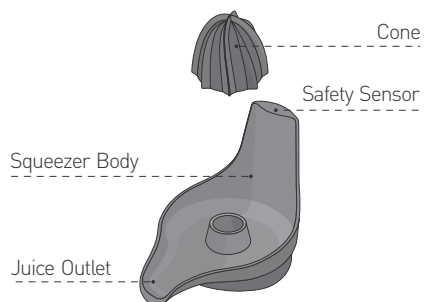

13 Chamber Rack

*Chamber Rack can not be separated after assembling

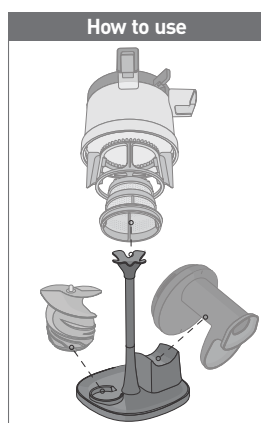
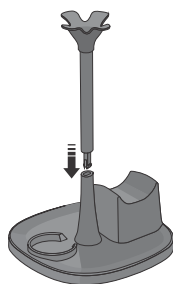

How to Disassemble : Chamber

NOTE: It is most convenient to first remove the whole chamber set, by lifting it vertical off the base and then follow step 1 to 4.

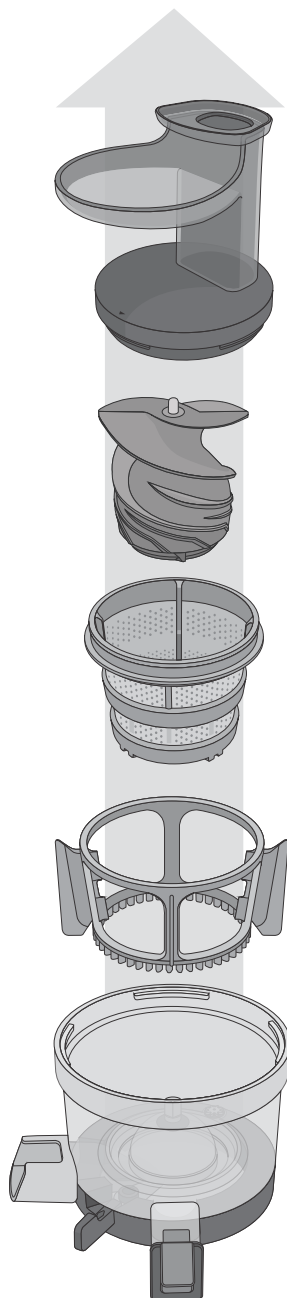

- 1 Turn the hopper counterclockwise and pull it up.

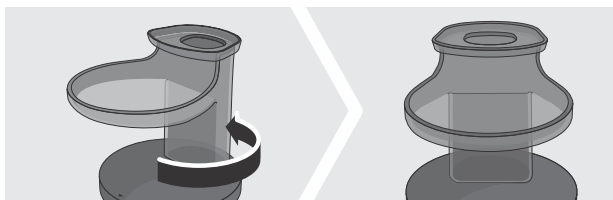

- 2 Disassemble by lifting the strainer and spinning brush from the chamber.

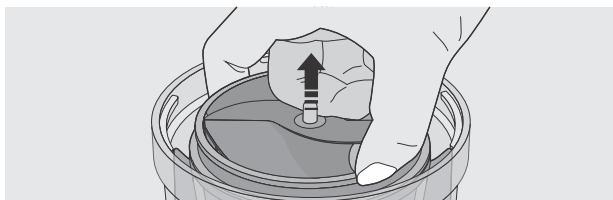

- 3 Pull out the squeezing screw holding both sides of wing.

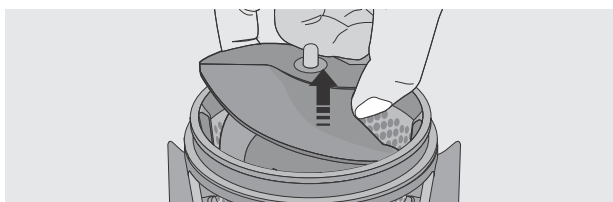

- 4 Disassemble the spinning brush and strainer.

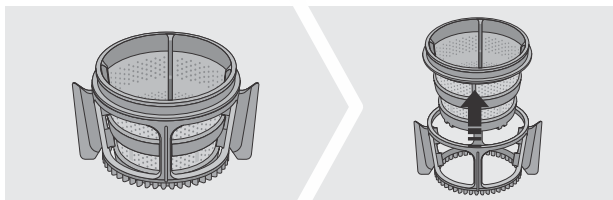

How to Prepare Ingredients / Use by Strainer Types

How to trim the ingredients For juicing

Apple · pear · kiwi · cucumber	Fruits and vegetables like Apple, pear, kiwi, cucumber etc. can be juiced with seeds and peels if desired.
Pomegranate · grapes · berries	Separate each grape from the cluster. Peel the pomegranate and use flesh only. Be careful not to use too much grapes/berries with seeds and clean the machine before it becomes clogged.
Watermelon · melon · orange · grapefruit · lemon	Peel off the skin of watermelon, melon, orange, grapefruit, lemon and cut them into right size.
Mango · cherry · peach · lemon	Fruits like mango, cherry, peach, lemon or plum, etc. have hard seeds which are hard to swallow. Those seeds might cause stoppage or parts damage, so they must be removed before using it.
Wheatgrass · chives · parsley · dill · celery · kale	Cut fibrous ingredients into small sized less than 3-4 cm. Ideally chop it to pieces of just 1 cm long. Put in small portions at a time. Ideally mix with carrot or beetroot for better throughput.
Ginger · Garlic · Carrot · Beetroot	When extracting juice from ingredients with many fibers, including ginger, slice thinly and insert slowly. When extracting juice from root vegetables, including ginger (carrot, dandelion, potato, beetroot, etc.), non-food materials such as dirt on the surface may damage the parts. Clean this thoroughly. When extracting a large amount of juice, repeat the process of "disassembling and cleaning after extracting juice from 1kg of ingredients".

How to prepare ingredients For making ice cream

Frozen fruit	Dice frozen fruits in small 1cm slices to make ice cream. Remove hard seeds before freezing. Please use seedless grapes. Take note that the product must be soft enough to chew before putting it in the icecream strainer. Some fruits require slight defrosting before they can be inserted.
---------------------	--

- ▶ Hard deep frozen items may damage the ice-cream strainer. Slightly defrost before use.
- ▶ Overfeeding frozen ingredients may damage the product. Please feed carefully in small portions and watch the operation of the juicer.

Use by strainer types

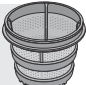
Fine Strainer		The fine strainer has tiny and fine holes good to make clean juice.
----------------------	---	--

Ice Cream Strainer		This is for making Smoothies, slush and ice cream with frozen fruits. Do not extract large amount of ingredients at once or put in large chunks of the ingredients. Some juice can come out of the pulp outlet or outside of the strainer when using slightly defrosted fruits. This is normal phenomenon and not a product failure. Do not use frozen water or ice cubes.
---------------------------	---	--

NOTE

This ice cream strainer is only for soft frozen fruits.
Do not use for crushing ice or grinding seeds or coffee beans.

How to assemble : For juicing

1
STEP

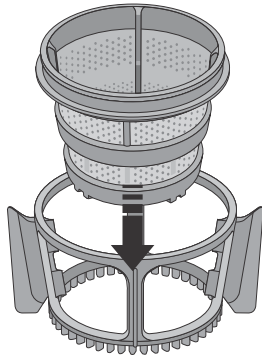

Assemble the strainer and spinning brush as shown in the picture.

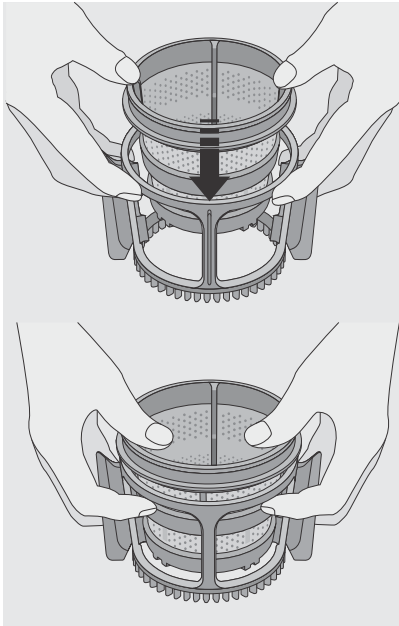

2
STEP

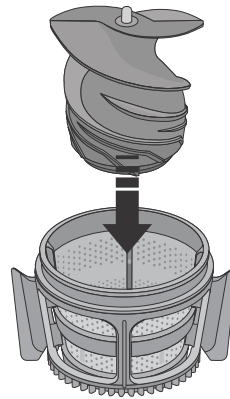

Assemble the squeezing screw into [STEP1].

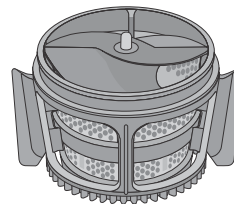
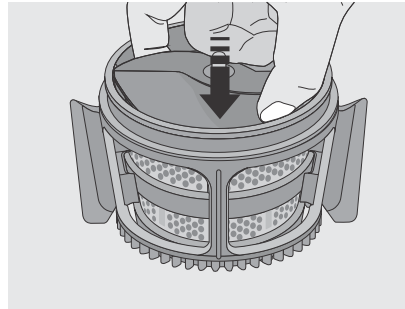

09

How to assemble : For juicing

3
STEP

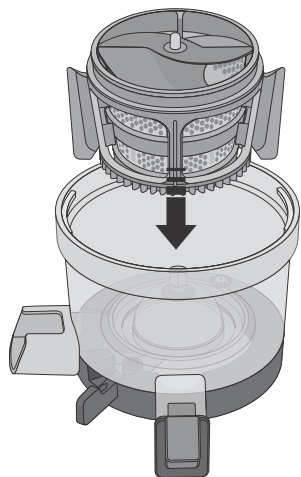

Place the assembled parts from [STEP 2] into the chamber by turning the strainer from side to side to fit the groove in the bottom bump of the chamber.

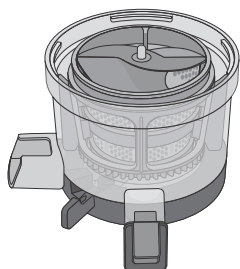
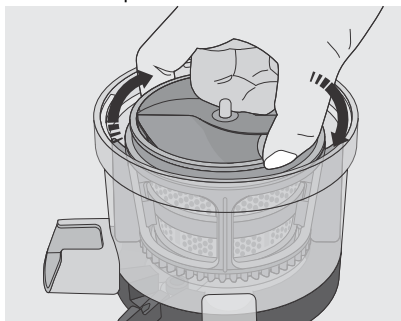

4
STEP

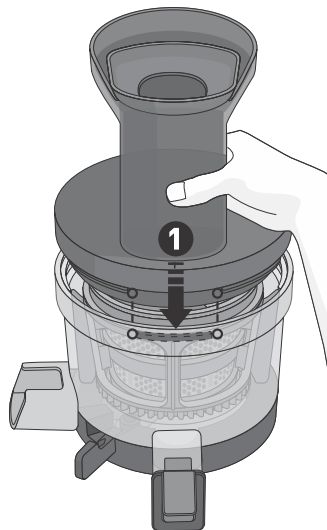

After putting the hopper on the chamber, turn it clockwise until it is locked completely.

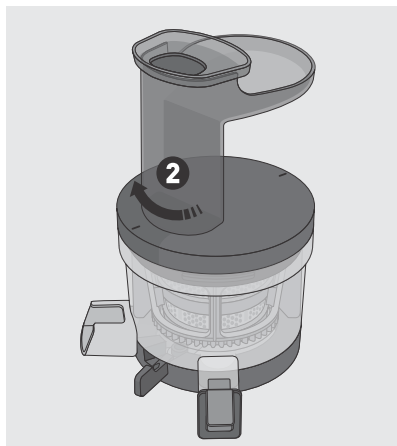

NOTE

The hopper can be operated when assembled in either direction.

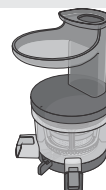

How to assemble : For making Ice cream

1

STEP

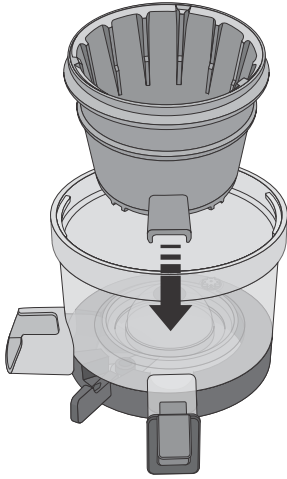

Assemble the chamber and ice cream strainer. Place the ice cream outlet align with juice outlet.

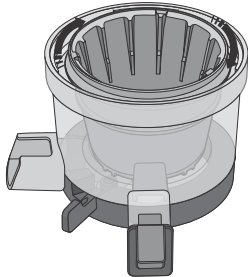
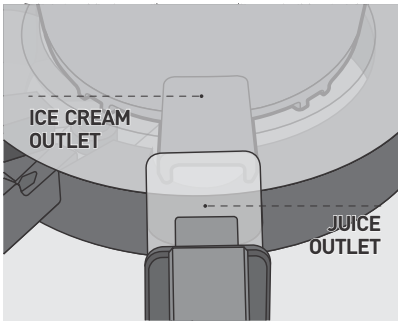

2

STEP

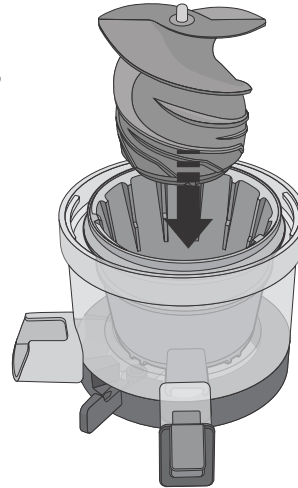

Press the squeezing screw into the assembled parts from [STEP 1] until the screw fits perfectly.

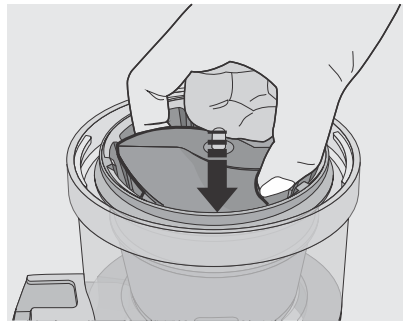

NOTE

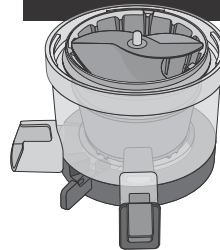

The spinning brush isn't needed for ice cream making.

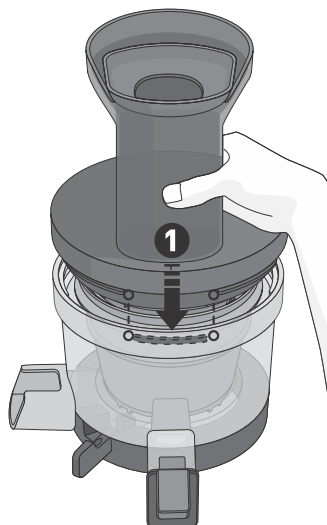
How to assemble : For making Ice cream**3**
STEP

After putting the hopper on the chamber, turn it clockwise until it is locked completely.

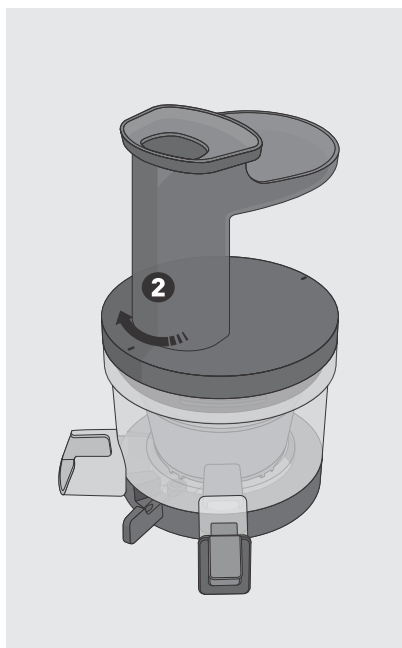
**NOTE**

The hopper can be operated when assembled in either direction.



How to assemble the chamber set and body

The assembling method is same regardless of strainer type.

- 1 Place the control lever of the chamber set to [● CLOSE] as image ①

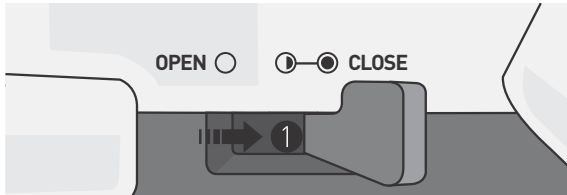

- 2 Assemble the bottom of the chamber to bump of the body. If the control lever is not placed at [● CLOSE] the chamber set and body will not fit completely.

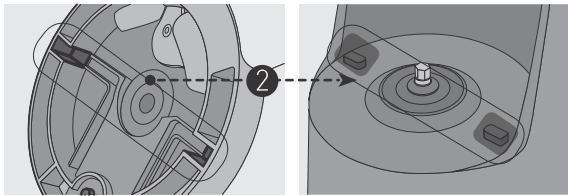

- 3 If the sign [▼] on the body and the sign <▲> behind of the chamber set are aligned well, it is perfectly assembled.

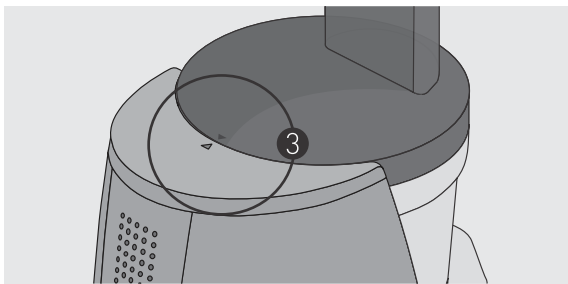

NOTE

The main body itself will not work.
The appliance will not work if the chamber set isn't assembled correctly even though it is on the body.

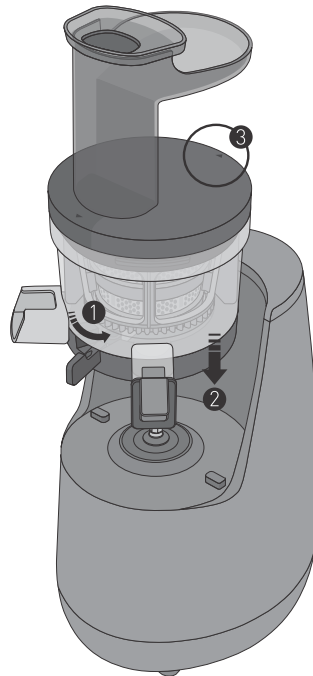

NOTE

If the hopper is assembled according to the safety sensor on the main body, the appliance works even the hopper is assembled in the opposite direction as the picture below.

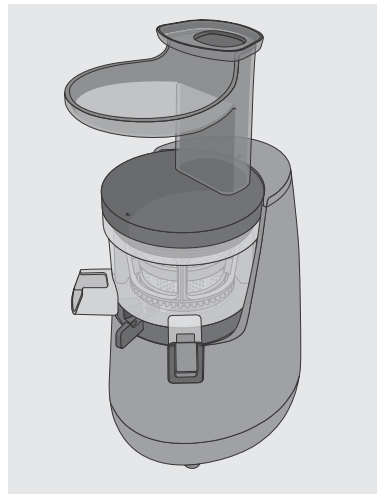

Cautions during Operation

Ingredients which needs caution and may cause damage or failure.

- Fruits with hard seeds such as persimmon, apricot, lemon, plum, peach, cherry etc. that are hard to chew with our teeth. Seeds should be taken out before extraction.
- For stalk vegetables with strong fiber such as parsley, dill, celery etc. should be cut into small sizes about 3-4cm or smaller before putting into the hopper chute.
- Do not put in sesame seeds, coffee beans, bark of the tree, pepper, etc. which cannot be extracted.
- Do not put in fruits preserved in alcohol, sugar, honey, etc. (grapes, apricot, berries, etc.).
- Do not insert ingredients that cannot be juiced due to their characteristics, such as figs, aloe and sea weed (Please contact the Customer Service Center for more information on which ingredients can be juiced).
- Extracting the juice from a large amount of root vegetables, including ginger, may cause damage or failure. Please repeat the process of "juicing 1kg, disassembling and cleaning".

We recommend you to drink green vegetable juice and fruit juice immediately after extraction rather than keeping them for long time.

Do not use for grinding grains.

- It may cause damage or failure.

Do not re-squeeze residues expelled through the pulp outlet.

- Soft fruits can be re-squeezed.

Do not operate the appliance before putting in the ingredients.

Do not use the appliance for more than 30 minutes continuously.

- It may cause a failure due to overheating of the motor.
- When using continuously, stop it and give it 5 minutes of interval and then you may use it again.

Never insert chopsticks or a spoon into Pulp outlet during the operation.

- Inserting such as chopsticks etc. into Pulp outlet during operation may cause them to get stuck into the spinning brush and cause damage to the parts.

Do not press the ingredients with anything except the pusher.

- It may stick to the screw and cause injury and failure.

Do not operate the switch with wet hands.

- It may cause electric shock or fire. Do not put foreign objects near the switch.

When you extract over 400ml at once, please open the control lever every 400ml to emit the pulp.

- The hopper can't be opened or it may cause damage when the pressure in the chamber increases.

Please use only the ice cream strainer when you put frozen fruits.

Do not put ice cubes, other ingredients and for grinding.

- It may cause damage or failure.

NOTE

Withered ingredients because of refrigerated for long term may make small amount of juice or impossible to make juice. If the unit is not cleaned immediately after use, a residue may dry and stick to the unit. This will make assembling and cleaning difficult as well as lead to performance degradation.

How to use : For juicing / Ice cream

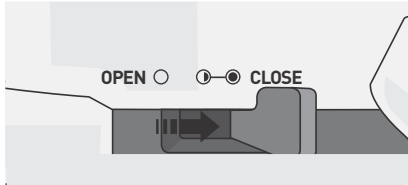

1 Place the lever [● CLOSE] position before operating.

The chamber will not be assembled with body if the control lever is not into CLOSE [● CLOSE] position.

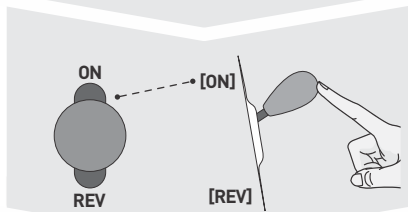

2 Press [ON] button to start.

For your safety, this appliance only works when it's correctly assembled with chamber set.

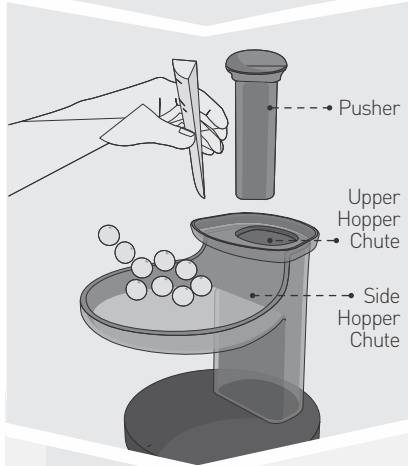

3 Put ingredients gradually in the hopper chute and press with the pusher.

Do not press the ingredients with anything except the pusher provided. Please put the ingredients as 3~4cm sizes.

When you use the ice cream strainer, the juice can be out through outlet and it is normal operation.

When you extract over 400ml at once, please open the control lever every 400ml to emit the pulp.

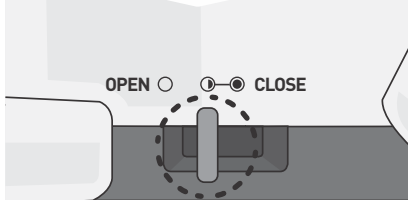

4 Juice : Put the lever in half-closed [●] position before putting the last ingredients.

Ice cream : Close [● CLOSE] the control lever to use.

The hopper will be opened easily as long as the residues in the strainer are released.

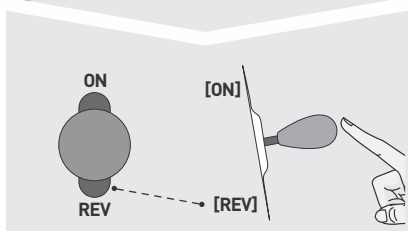

5 After extraction is completed, place the switch in the [REV] position.

Stop the machine slowly after press the button for safety and product performance.

NOTE

When using [ON] or [REV] button, make sure that the squeezing screw stops completely.

15

How to use the control lever by mode

- The control lever is between the juice cap and pulp outlet.
- The control lever has various functions and can help to facilitate the juicing and cleaning process.

[●CLOSE] Preparation-Juice Extraction Mode

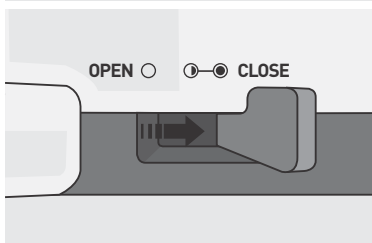

For general ingredients, the extraction rate is good when you close [●CLOSE] the lever during operation. When you extract over 400ml at once, please open the control lever every 400ml to emit the pulp.

For juicing fruits or berries with seeds, such as grapes, Red berries, and pomegranates, place the control lever into close [●CLOSE] and switch into half-closed [●] position when juice begins to come out.

[●CLOSE] Ice cream Mode

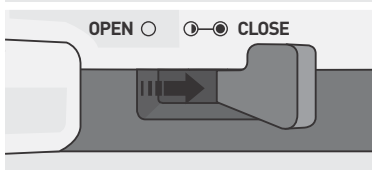

Close [●CLOSE] the control lever to use since the pulp is not released separately.

[●] Completion, Simple Cleaning Mode

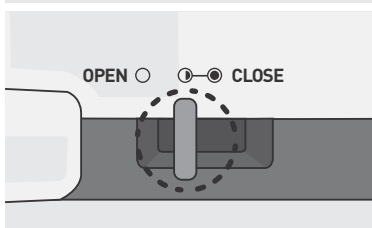

Place the control lever into half-closed [●] the control position when putting in the last ingredients and release the residues. The hopper will open easily when the residues in the strainer are released.

For Simple Cleaning Mode, put the lever in half closed [●] position and release the residues.

[○OPEN] Cleaning Mode

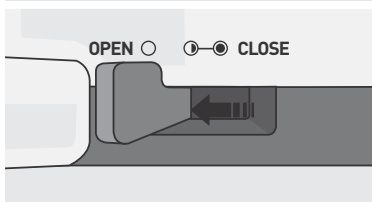

When detaching and cleaning the chamber, put the lever completely in [○OPEN] position. You can easily and conveniently clean the chamber.

The control lever can not move to the [○OPEN] position when the chamber is placed on the main body.

NOTE

When it is hard to open Hopper after operation. Put the lever in half-closed [●] position and press [REV] button for 3~5 seconds. Repeat this for 2~3 time and the hopper will be opened easily.

How to use the control lever by ingredients (Juicing)

NOTE

Use the control lever by the properties of each ingredients, you can make a more delicious juice. When you extract over 400ml at once, please open the control lever every 400ml to emit the pulp. The hopper can't be opened or it may cause damage when the pressure in the chamber increases.

Ingredients

Apple, pear, melon, watermelon, strawberry, blueberry, orange, grapefruits, lemon, mango, plum, peach, cherry, persimmon, pineapple, wheat-grass, parsley, celery, dandelion, carrot, ginger, potato, beet, tomato, paprika, broccoli, cauliflower, cabbage, kale, spinach (Cooked) sweet potato, pumpkin, corn.

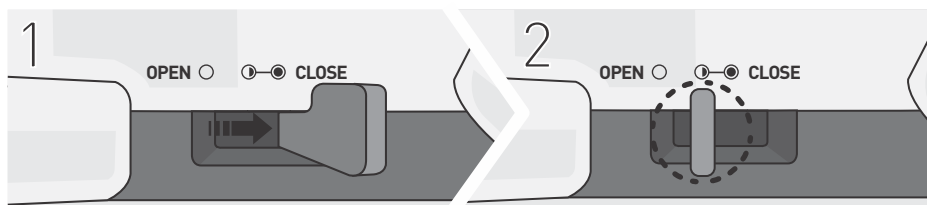

Start from control lever in [●] **CLOSE** position.

When extraction is almost finished, place the control lever into [◐] half-opened position.

Ingredients with seed

Grapes, pomegranate, kiwi, tomato, blackberry, raspberry, mulberry, etc.



Start from control lever in [●] **CLOSE** position.

When juice starts to come out, place the control [◐] half-opened position.

Mix with (nut)milk

Banana, strawberry, blueberry, etc.

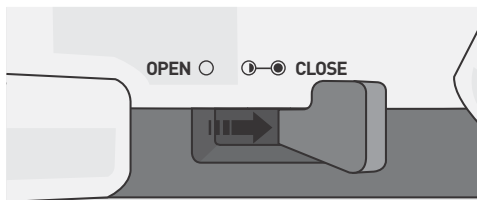

When the squeezing screw stops during operation

- The appliance may stop if ingredients are overloaded or inserted quickly.
- Gradually insert ingredients, since the product squeezes them instead of grinding.

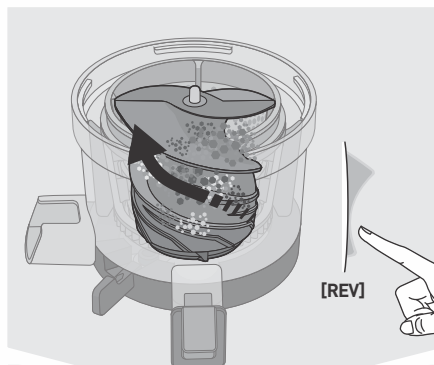

- 1 Press [REV] button on the operating switch for about 3~5 seconds and stop it. Repeat this 2~3 times.

"Reverse" is a function that rotates (or operates) the screw (motor) in the opposite direction.

Reverse rotation operates only while holding the switch in [REV] position, and shuts off when switch is released.

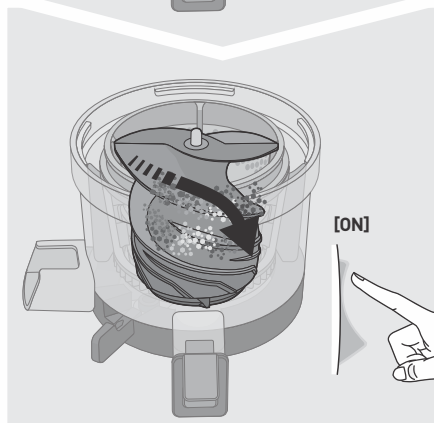

- 2 Press [ON] button to operate after reverse operation is completely stopped.

When using [ON] or [REV] button, make sure that the squeezing screw stops completely.

NOTE

Even after following the directions above and this still doesn't work, please unplug the power cord and disassemble chamber set, and clean it. And try it again.

Caution when using operation button

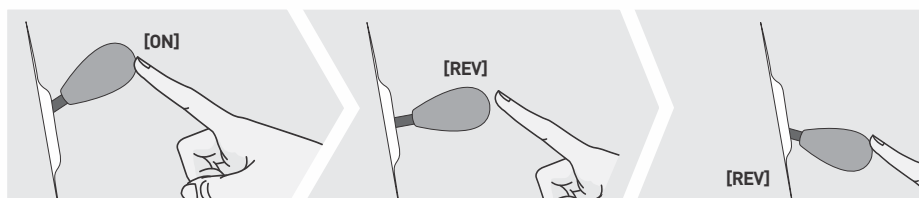

NOTE

In case of reversing during operation, press [REV] button shortly to stop the appliance, then you press [REV] button for operation. From the feature of the product, even though you stop the operation, it doesn't stop right away. It rotates slowly then stops. If the rotation stops completely, you may press the button to any direction you want.

Assembling and cleaning for squeezer

How to assemble the squeezer set and body

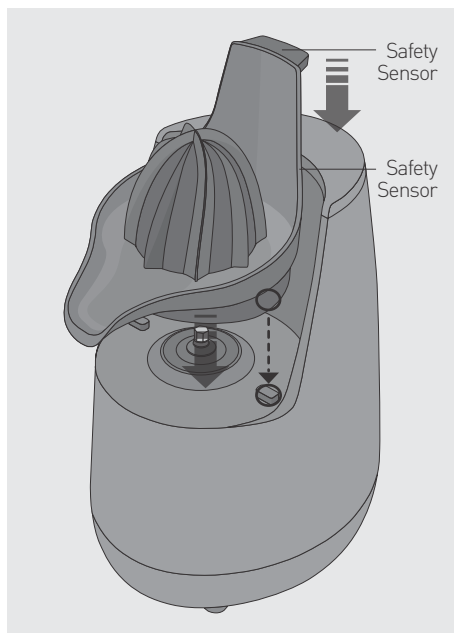

- 1 Mount the serving spout on the body.**
Align the grooves of the serving spout bottom with the bumps of the body.

Cleaning

1. Turn off and the remove the plug from the power outlet before cleaning.
2. Remove the cone and serving spout from the body and clean the parts under running water.
3. Rinse or wash all squeezer parts immediately after use. Dried citrus pulp is difficult to clean.

NOTE

**DO NOT WASH AT HIGH TEMPERATURES OF 80° OR HIGHER.
DO NOT PUT THE APPLIANCE AND PARTS IN A DISHWASHER, DRYER OR A MICROWAVE ETC.
It may cause a failure or parts deformation.**

Using the squeezer

How to use the squeezer

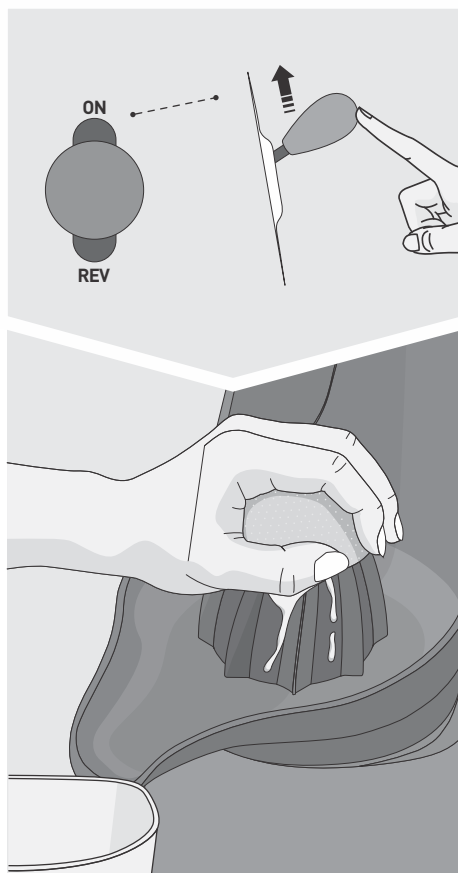

- 1 Press the [ON] button to turn on.**
Prepare the juice cup under the serving spout.

- 2 Cut the citrus fruit in half. Place a citrus fruit half onto the cone and push down gently.**
If you extract an excessive amount of ingredients, it may overflow.

How to use squeezer

Remove seeds before extract. If not removed, it may contain the seeds in juice.

If you want clear juice, use the Versapers chamber for juicing.

Please wash the fruits before using them on the squeezer.

Please use fruit at room temperature than the cold fruit from the fridge in order to obtain a large amount. Please select fruits of smooth and bright colors and avoid fruits that have a damaged or dried out peel. We recommend you drink juice immediately after extraction rather than storing it for long time.

How to Clean

Cleaning for parts

- 01 Unplug the power cord with dry hands after the unit has been completely stopped.
- 02 Remove the chamber set from the main body. Twist the chamber cover to open and lift up the parts in order to disassemble the unit.
- 03 Use a cleaning brush and wash the chamber set under running water.
- 04 Open the control lever **[OPENO]** and juice cap to wash the chamber.
- 05 Wipe the main body with a damp towel or a soft cloth.
- 06 The silicone packing can be disassembled and washed. (Including juice cap packing, silicone brush)
- 07 You can clean the product by soaking it in water with diluted baking soda or vinegar for about 30 minutes.

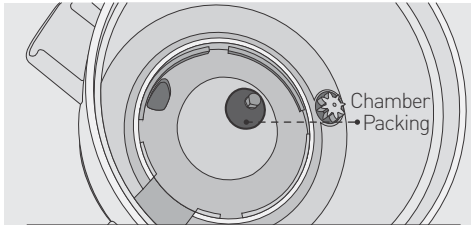

The chamber packing can't be disassembled. Do not disassemble the chamber packing. If you try to disassemble the chamber packing, it might be damaged.

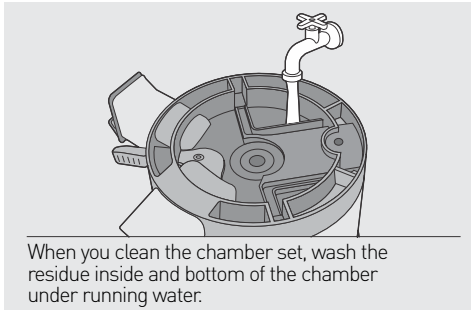

When you clean the chamber set, wash the residue inside and bottom of the chamber under running water.

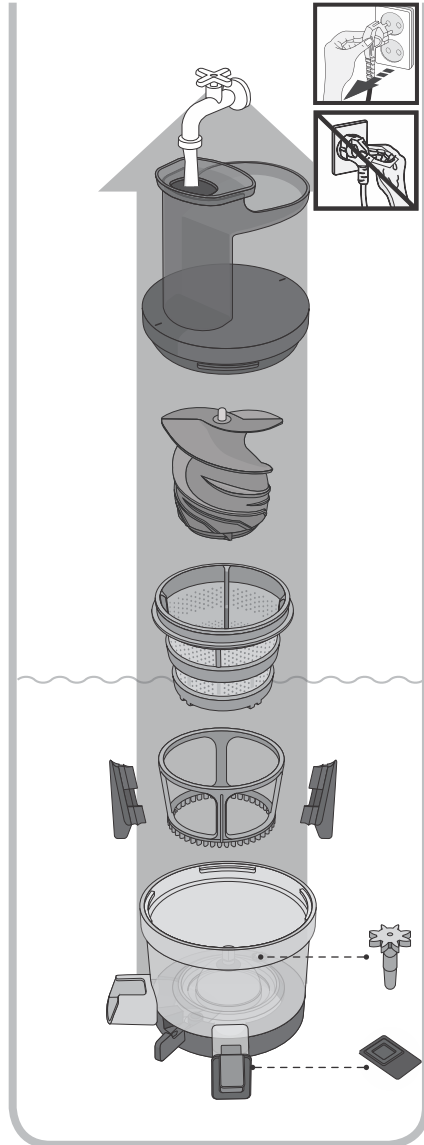

NOTE

If the unit is not cleaned immediately after use, a residue may dry and stick to the unit. This will make disassembling and cleaning difficult as well as lead to performance degradation. Do not wash with hot or boiling water, an iron scrubber, abrasive material, sink solvents, or sharp cleaning tools. Do not put it in a dishwasher or dish dryer. After washing, thoroughly and naturally dry, and store in a clean area.

21

How to Clean : Silicones

Juice Cap Packing

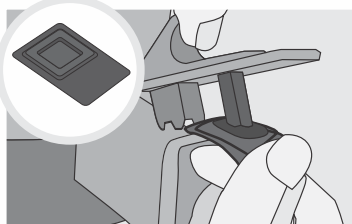

Open the juice cap, hold the chamber and juice cap with one hand, and remove the juice cap packing with your other hand to disassemble.

Please be careful not to drop or damage the juice cap and chamber when disassembling the unit.

Mid gear

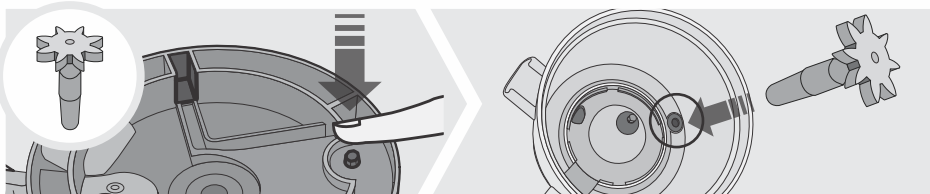

Push the mid gear from the bottom side of the chamber then the gear will be come out.

Place the mid gear back after cleaning.

Silicone brush

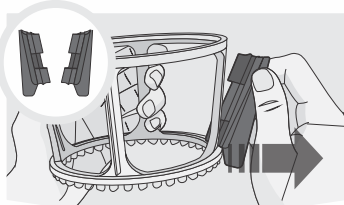

1 Remove the silicone brush from the spinning brush holder.

Please follow the recommended method to separate the silicone brush. Otherwise, it may cause damage of spinning brush holder and silicone brush.

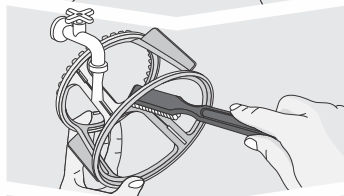

2 Use a cleaning brush and wash the inside and outside of the spinning brush holder under running water.

Wash the silicone brush under running water as the same method.

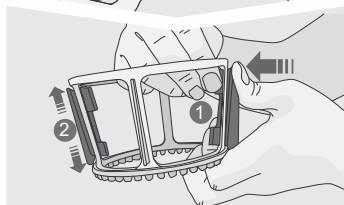

3 After cleaning, attach the silicone brush by pushing on the back of the brush holder, ① while pulling the inner wing inward with your other hand as shown in the picture. Pull until it cannot be pulled any further. There is a risk of damage if the product is used without being fully assembled. ② Grab the top and bottom of the outer wing and pull them tight.

If the silicone brush cannot be inserted properly, the packing may become wrinkled or fall out during juice extraction.

Before Requesting for Repair

If you need additional information, please contact your local Customer Service Center or visit www.versapers.com. When applying for after-sales service, please have the model number and manufacturer's serial number available. It can be found on a sticker on the bottom of the main body.

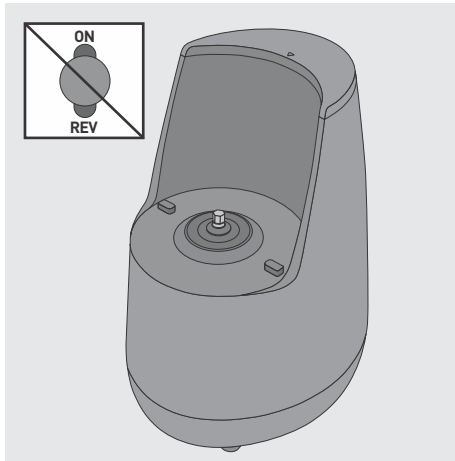

01 The main body itself will not work.

The main body itself will not work. For your safety, this unit only works when main body is correctly assembled with the chamber set.

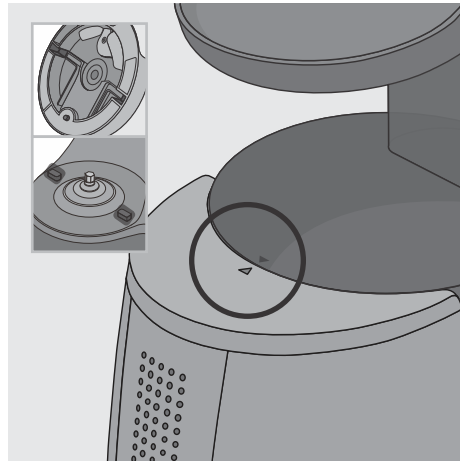

02 Please assemble according to the safety sensor.

For your safety, this unit only works when it's correctly assembled.

03 The Appliance does not work.

Make sure that the power cord is properly plugged in.

Check if the hopper is assembled properly.

The appliance may not operate when used for an extended period of time (more than 30 minutes). It will work normally after the body (motor) cools down.

If the hopper has not been locked into place, the appliance will not operate for safety reasons.

Check if the appliance is assembled according to the directions in the manual.

Refer to instructions for assembly in the manual or consult with your Customer Service Center for additional assistance.

04 The appliance stops during normal operation.

Have you in heavy loads or large pieces of ingredients into the appliance?

Refer to page 17 of the manual and follow the guideline for using [REV] button.

If the issue is not resolved after following the above process, please contact your local Customer Service Center.

05 There are fine lines or scratch marks around the squeezing screw.

These are molding marks resulting from the normal manufacturing process.

This is a normal product and there is no problem for use.

06 Chamber set does not fit into the base.

If the lever is in OPEN  position, the chamber set does not fit in to the base. Before assembling

 CLOSE position.

23

Before Requesting for Repair

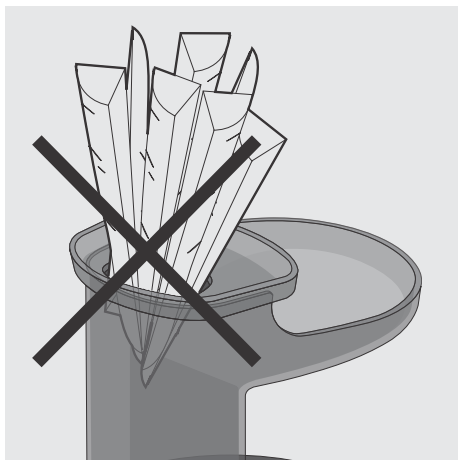

07 Do not insert too many ingredients at once.

If you insert an excessive amount of ingredients or thick ingredients, the unit may stop.



08 Do not use in ways other than pressing on the pusher in the inlet.

It may cause damage, injury, etc.

09 Juice leaks over the base.

Have you inserted a lot of ingredients into the hopper chute?

If you insert a large amount of ingredients compared to the pulp outlet, the packing is slightly pushed away, so the juice leaks out of the gap. Do not put too much ingredients by force and just put gradually for extraction. Please contact the Customer Service Center if juice continues to leak from above the body.

10 The hopper does not open.

There might be a lot of residues inside. Put the lever in half-closed position, and press [ON] button to release residues. Press [REV] button for 3-5 seconds and stop it. Repeat this process 2-3times.

Have you placed any foreign substances or solid objects (hard seed such as persimmon seed) in the juicer?

Press [REV] button and push the ingredients back up toward the hopper chute. Do not attempt to open by force. Please contact your local Customer Service Center for assistance.

11 The Chamber shakes when squeezing.

Slight shaking may be caused by the motor.

Depending on the texture of the ingredient, there may be slight to more pronounced shaking of This is a normal phenomenon as squeezing screw rotates and it is not a malfunction. Hard ingredients (e.g carrot, potato, radish, beet, kohlrabi, etc.) may cause more shaking than soft ingredients.

Product Specifications / Warranty

Product Name	Versapers Emotion	Cord Length	1.4 m
Model Name	5G	Motor	Single-phase induction motor
Rated Voltage	230 ~ 240 V	Fuse	250 V 8 A
Rated Frequency	60 Hz	Weight	6.3 kg
Rated Power Consumption	150 W	Outward Dimension	Width 280 mm Length 187 mm Height 428 mm
RPM	43 rpm	Squeezer Dimension	Width 137 mm Length 191 mm Height 137 mm
Rated Operating Hour	Less than 30 minutes	Squeezer Weight	205 g

Warranty

You can register your purchase on the website of Versapers. <http://versapers.com/warranty>
Your warranty is executed at the local distributor where you have purchased the product.

Always keep your invoice or receipt as original proof of purchase in case of making a claim on the warranty. This certifies that the Versapers Slow Juicer is warranted by Versapers to be free from defects in material construction and workmanship.

The motor warranted for five (10) years and other parts are warranted for one (2) year from the date of purchase to the original purchaser.

This warranty does not apply to damages caused by accident, misuse, abuse, commercial use, alteration, failure to follow operating instructions, or damage caused by parts or service unauthorized by Versapers.

Damages caused by transportation must be claimed with carrier. Versapers disclaims all responsibilities for consequential damages from incidental losses caused by use of this appliance.

If service should be necessary, please contact our local Customer Care Centre for technical support.

versapers[®]
The juice revolution

Manufacture: VERSAPERS
Versapers webpage: www.versapers.com

25

MEMO

When diet is wrong,
medicine is of no use
When diet is correct,
Medicine is of no need

Let food be thy medicine

versapers[®]
The juice revolution

WWW.VERSAPERS.COM
A DUTCH BRAND, MADE IN SOUTH KOREA
Copyright© All Rights Reserved by Versapers
5G V2018-01 ENG